



FANSHAWE YACHT CLUB AND SAILING SCHOOL

FIRE & SAFETY PLAN

NEAREST HOSPITAL - UNIVERSITY HOSPITAL 339 WINDERMERE ROAD, LONDON

EMERGENCY PHONE - 911 FIRE, POLICE, AMBULANCE

UPPER THAMES RIVER CONSERVATION AUTHORITY EMERGENCY PH. - 519-951-6181

MONTHLY INSPECTIONS:

FIRE EXTINGUISHER, FIRE BLANKETS, DEFIBRILLATOR, LIFE RINGS, RESCUE HOOKS, FIRST AID KITS.

FYC BOATS TO HAVE:

BAILER, SIGNAL DEVICE, ROPE, PADDLE, AND OTHER EQUIPMENT AS PER LATEST EDITION OF CANADIAN SAFE BOATING GUIDE.

LEGEND

- FYC PROPERTY FENCE
- ROADWAY
- FIRE EXTINGUISHER ABC 4LBS
- FIRE BLANKET
- DEFIBRILLATOR
- LIFE RING & RESCUE HOOK
- PHONE
- STEEL SHIPPING CONTAINER
- FIRST AID KIT
- TORNADO SHELTER AREA

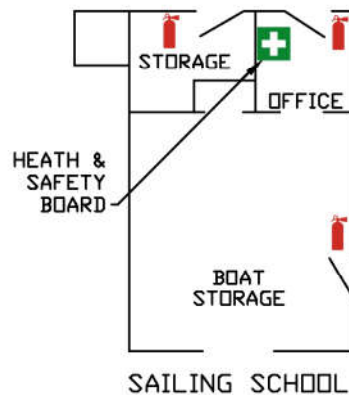
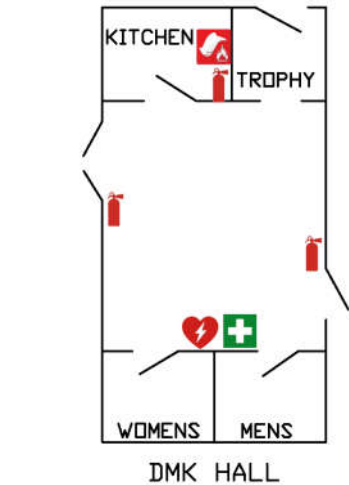
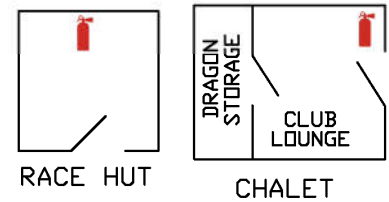
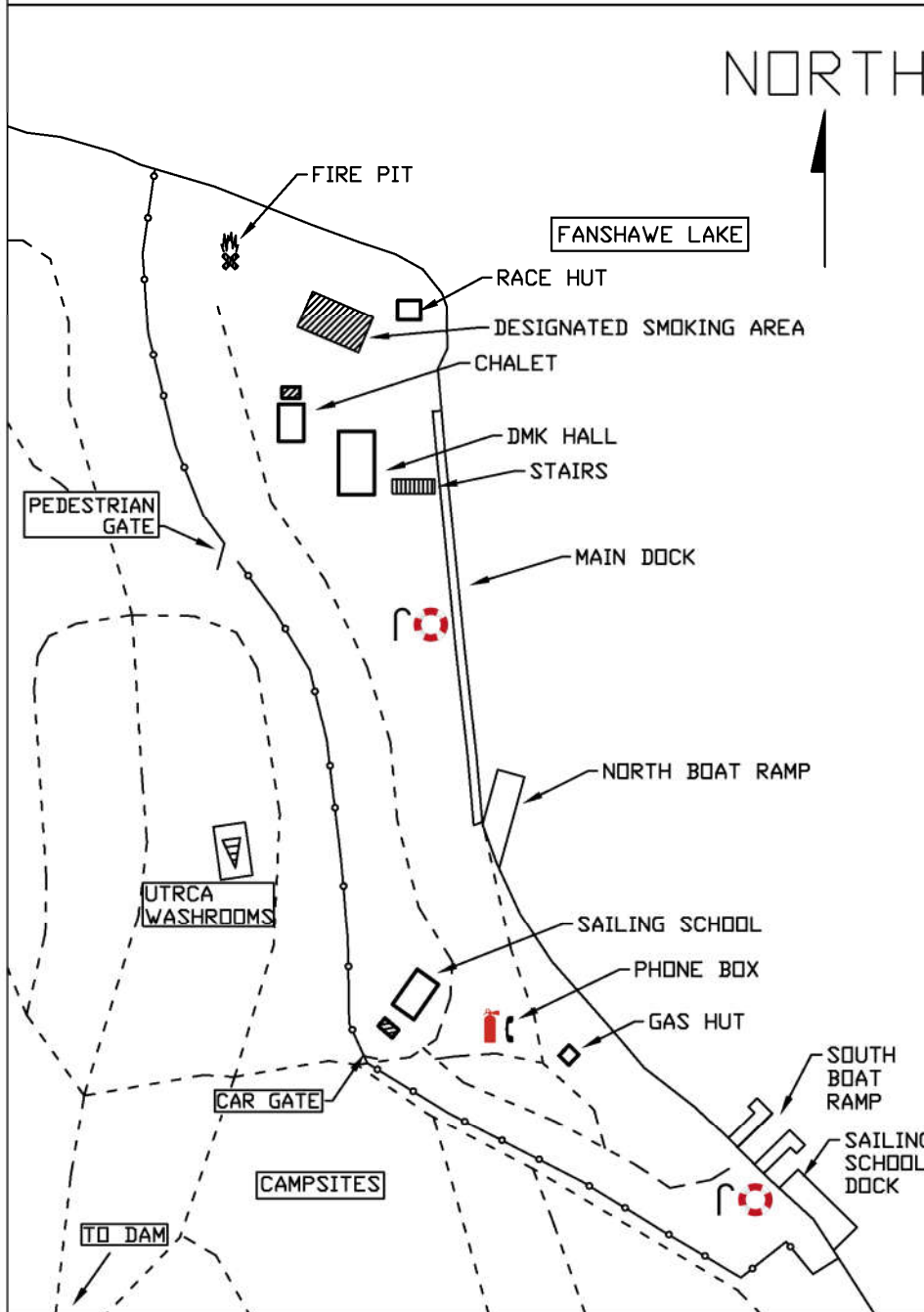

*****NO SMOKING/VAPING ON GROUNDS EXCEPT IN DESIGNATED SMOKING AREA*****